

# A.C.E.®

THE A.C.E.®, ALWAYS EVOLVING BUT STILL  
THE ORIGINAL. THE PET-FRIENDLY, FAMILY-  
FRIENDLY MOTORHOME BUILT FOR  
EVERY ADVENTURE. E BUILT FOR  
EVERY ADVENTURE.



Made to fit.





# ACE.®

Looking in the rearview mirror as the sun sets.

Watching the snow-capped mountains pass behind you.

So where to next?

In a 2020 A.C.E.® from Thor Motor Coach, you're  
creating the good times while others pass them by.





# EXTERIOR OPTIONS

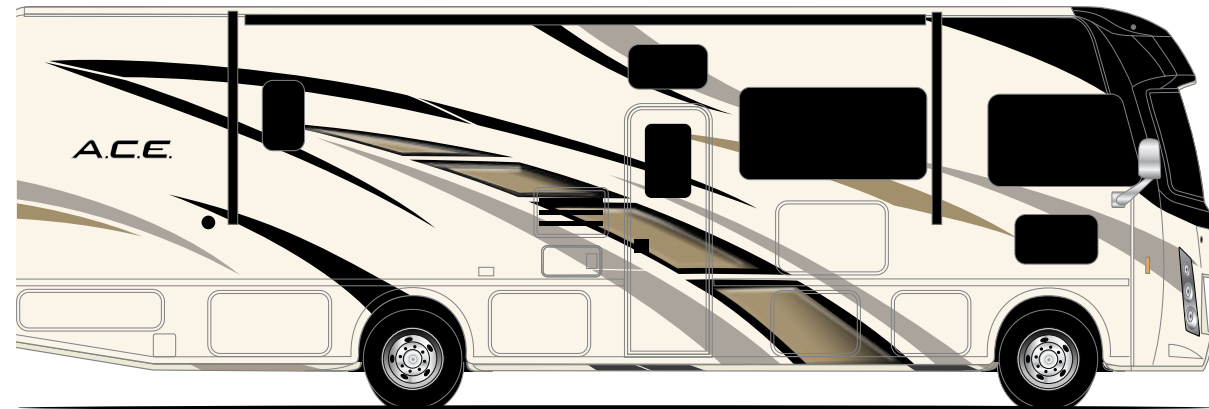

COSTA MESA II **FORD-MAX**

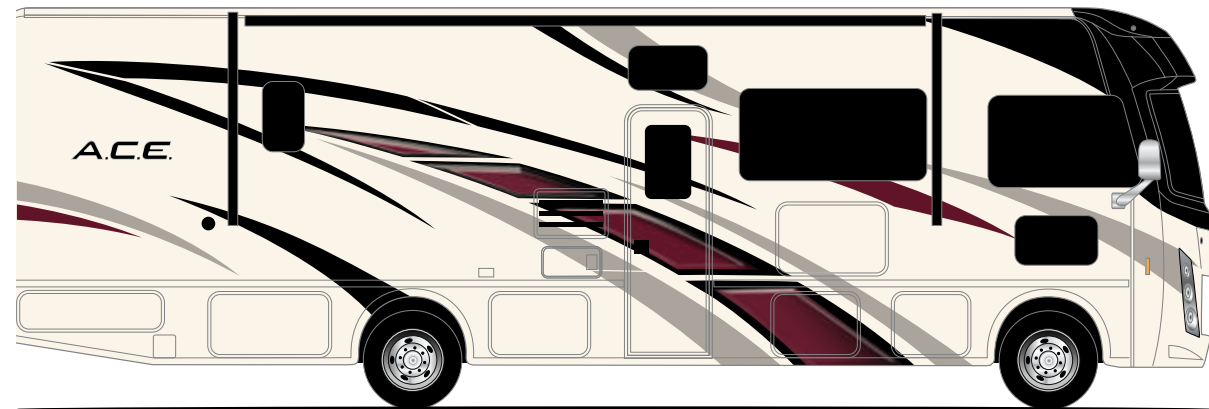

PASADENA II **FORD-MAX**



## TRITON® V10 ENGINE

The 6.8L V10 engine has a proven track record of durability and low-hassle maintenance. Extremely smooth running with a commanding 320-horsepower and 460 lb.-ft. of torque.

## POWER 4-WHEEL DISC ANTI-LOCK BRAKES

Maintains brake balance in heavy use and varying road conditions. Reduces wheel lock up and helps maintain superior steering control.

## TORQSHIFT™ 6-SPEED AUTOMATIC TRANSMISSION

Provides crisp, firm and quick shifting without sacrificing driver comfort, whichever comes first.

## LIMITED WARRANTY

The Ford® Motorhome Chassis has a Limited Warranty for 3 years or 36,000 miles and a Powertrain Limited Warranty for 5 years or 60,000 miles, whichever comes first.









FLOOR PLANS

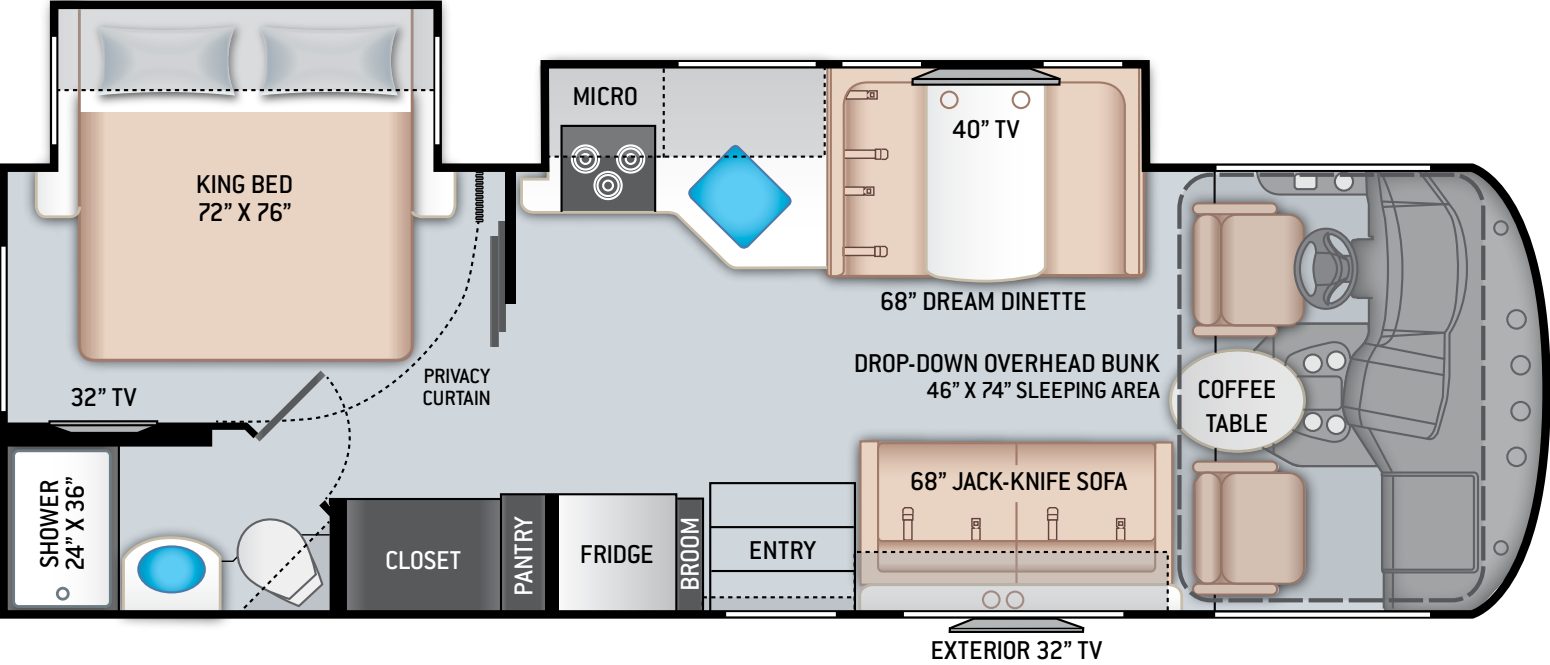

27.2

SPECIFICATIONS

27.2

|                                     |                   |
|-------------------------------------|-------------------|
| CHASSIS                             | Ford              |
| GROSS VEHICLE (GVWR)                | 16,000            |
| GROSS COMBINED (GCWR)               | 23,000            |
| WHEEL BASE                          | 178"              |
| EXTERIOR LENGTH (W/O LADDER)        | 28'-9"            |
| EXTERIOR HEIGHT (W/AC)              | 12'-2"            |
| EXTERIOR WIDTH (W/O MIRRORS)        | 99"               |
| INTERIOR HEIGHT (LIVING AREA)       | 84"               |
| AWNING SIZE                         | 19'               |
| FUEL (GAL)                          | 80                |
| LPG (LBS)                           | 88                |
| FRESH/WASTE/GRAY WATER (GAL)        | 50 / 40 / 33F-40R |
| WATER HEATER (GAL)                  | 6                 |
| FURNACE (BTUS)                      | 30,000            |
| EXTERIOR STORAGE CAPACITY (CU. FT.) | 71                |
| HITCH WEIGHT RATING (LBS)           | 8,000             |

FLOOR PLANS

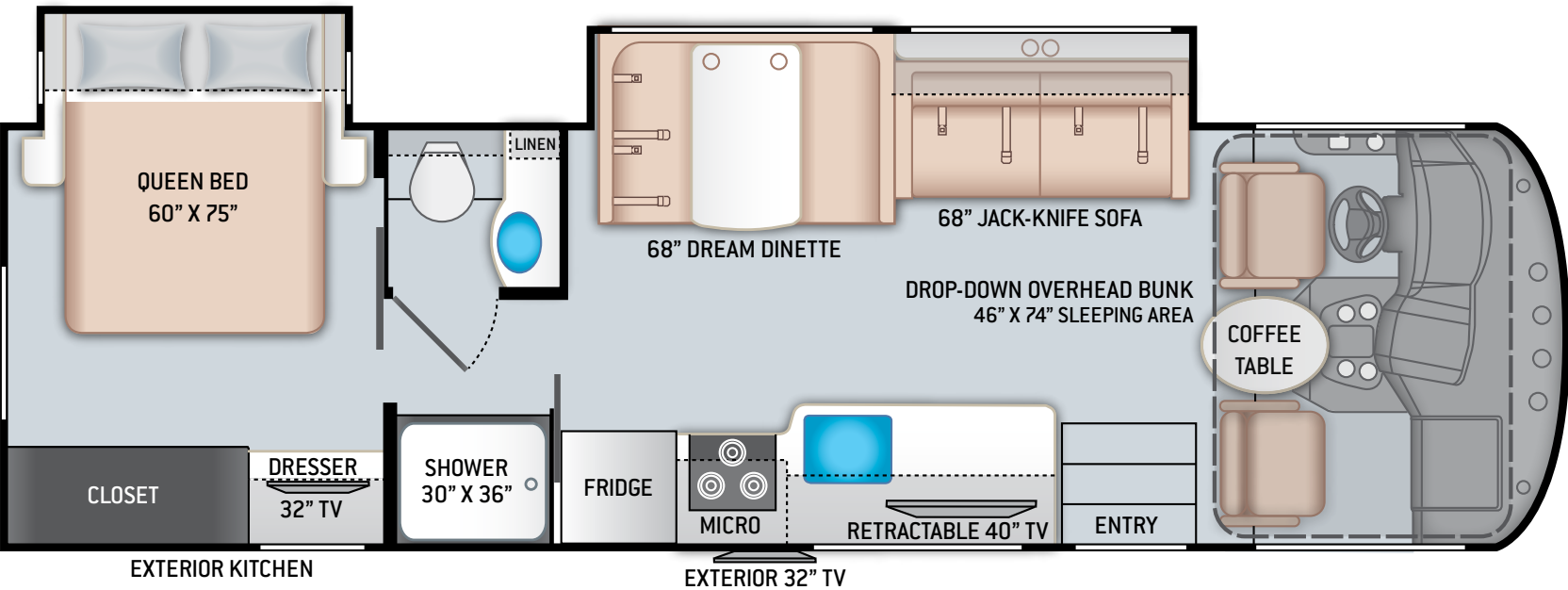

30.3

SPECIFICATIONS

|                                     |              |
|-------------------------------------|--------------|
|                                     | 30.3         |
| CHASSIS                             | Ford         |
| GROSS VEHICLE (GVWR)                | 18,000       |
| GROSS COMBINED (GCWR)               | 23,000       |
| WHEEL BASE                          | 190"         |
| EXTERIOR LENGTH (W/O LADDER)        | 31'          |
| EXTERIOR HEIGHT (W/AC)              | 12'-2"       |
| EXTERIOR WIDTH (W/O MIRRORS)        | 99"          |
| INTERIOR HEIGHT (LIVING AREA)       | 84"          |
| AWNING SIZE                         | 19'          |
| FUEL (GAL)                          | 80           |
| LPG (LBS)                           | 88           |
| FRESH/WASTE/GRAY WATER (GAL)        | 50 / 40 / 40 |
| WATER HEATER (GAL)                  | 6            |
| FURNACE (BTUS)                      | 35,000       |
| EXTERIOR STORAGE CAPACITY (CU. FT.) | 85           |
| HITCH WEIGHT RATING (LBS)           | 8,000        |

FLOOR PLANS

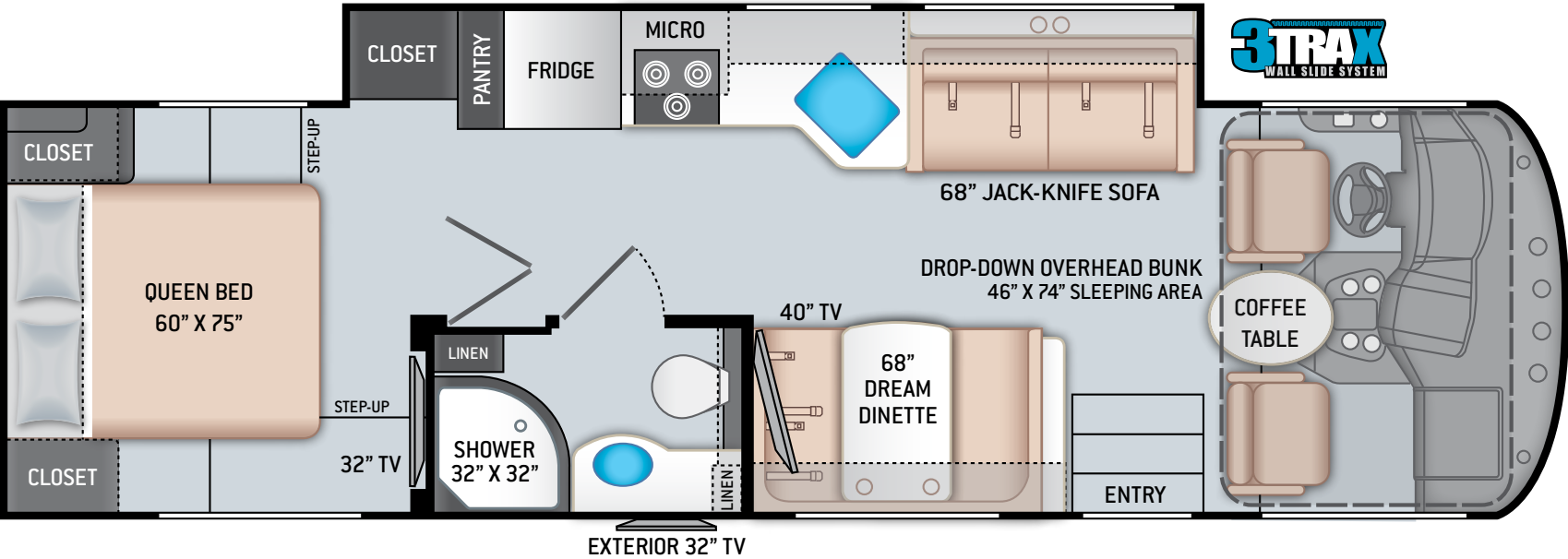

30.4

SPECIFICATIONS

|                                     |              |
|-------------------------------------|--------------|
|                                     | 30.4         |
| CHASSIS                             | Ford         |
| GROSS VEHICLE (GVWR)                | 18,000       |
| GROSS COMBINED (GCWR)               | 23,000       |
| WHEEL BASE                          | 208"         |
| EXTERIOR LENGTH (W/O LADDER)        | 31'-6"       |
| EXTERIOR HEIGHT (W/AC)              | 12'-2"       |
| EXTERIOR WIDTH (W/O MIRRORS)        | 99"          |
| INTERIOR HEIGHT (LIVING AREA)       | 84"          |
| AWNING SIZE                         | 16'          |
| FUEL (GAL)                          | 80           |
| LPG (LBS)                           | 88           |
| FRESH/WASTE/GRAY WATER (GAL)        | 50 / 40 / 47 |
| WATER HEATER (GAL)                  | 6            |
| FURNACE (BTUS)                      | 35,000       |
| EXTERIOR STORAGE CAPACITY (CU. FT.) | 130          |
| HITCH WEIGHT RATING (LBS)           | 8,000        |

FLOOR PLANS

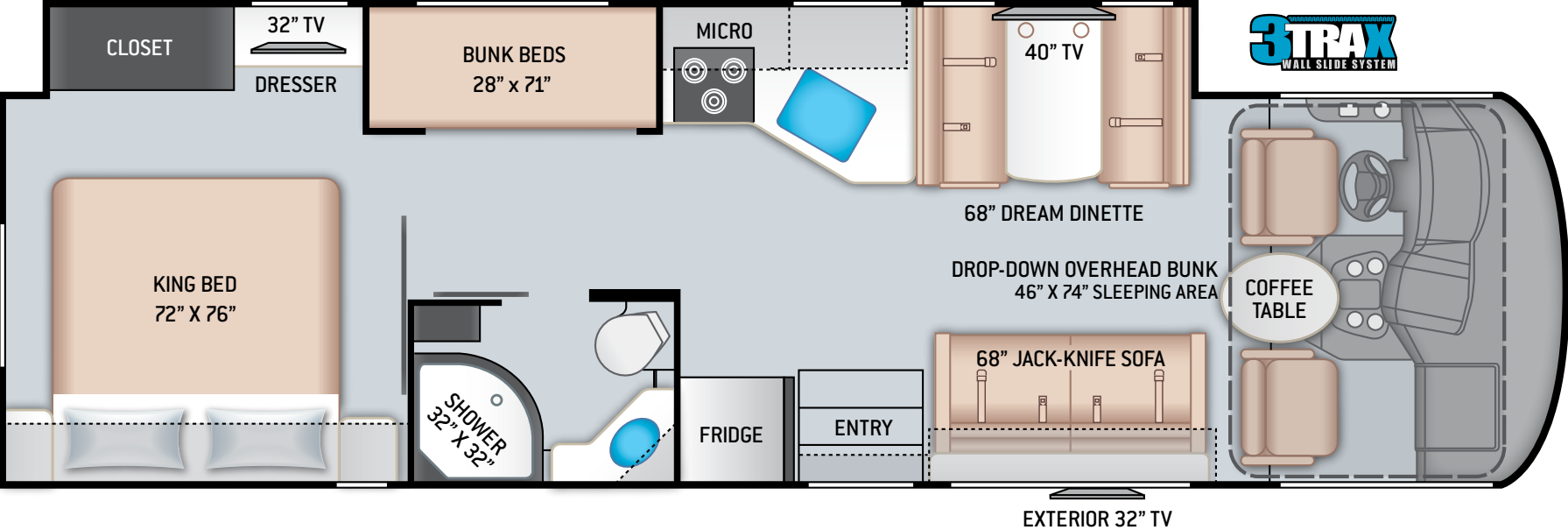

32.3

SPECIFICATIONS

|                                     |              |
|-------------------------------------|--------------|
|                                     | 32.3         |
| CHASSIS                             | Ford         |
| GROSS VEHICLE (GVWR)                | 18,000       |
| GROSS COMBINED (GCWR)               | 23,000       |
| WHEEL BASE                          | 208"         |
| EXTERIOR LENGTH (W/O LADDER)        | 33'-5"       |
| EXTERIOR HEIGHT (W/AC)              | 12'-2"       |
| EXTERIOR WIDTH (W/O MIRRORS)        | 99"          |
| INTERIOR HEIGHT (LIVING AREA)       | 84"          |
| AWNING SIZE                         | 19'          |
| FUEL (GAL)                          | 80           |
| LPG (LBS)                           | 88           |
| FRESH/WASTE/GRAY WATER (GAL)        | 50 / 40 / 40 |
| WATER HEATER (GAL)                  | 6            |
| FURNACE (BTUS)                      | 35,000       |
| EXTERIOR STORAGE CAPACITY (CU. FT.) | 112          |
| HITCH WEIGHT RATING (LBS)           | 8,000        |



FLOOR PLANS

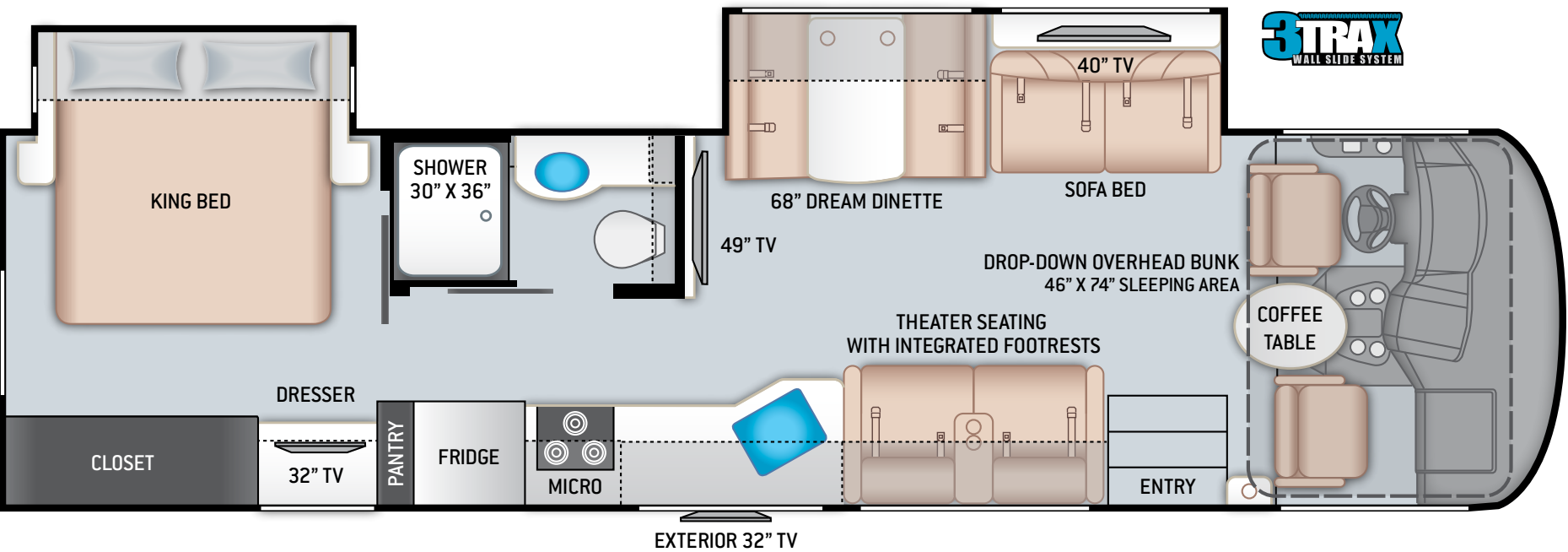

33.1

SPECIFICATIONS

|                                     |              |
|-------------------------------------|--------------|
|                                     | 33.1         |
| CHASSIS                             | Ford         |
| GROSS VEHICLE (GVWR)                | 20,500       |
| GROSS COMBINED (GCWR)               | 26,000       |
| WHEEL BASE                          | 228"         |
| EXTERIOR LENGTH (W/O LADDER)        | 34'-8"       |
| EXTERIOR HEIGHT (W/AC)              | 12'-2"       |
| EXTERIOR WIDTH (W/O MIRRORS)        | 99"          |
| INTERIOR HEIGHT (LIVING AREA)       | 84"          |
| AWNING SIZE                         | 19'          |
| FUEL (GAL)                          | 80           |
| LPG (LBS)                           | 88           |
| FRESH/WASTE/GRAY WATER (GAL)        | 50 / 40 / 40 |
| WATER HEATER (GAL)                  | 6            |
| FURNACE (BTUS)                      | 35,000       |
| EXTERIOR STORAGE CAPACITY (CU. FT.) | 127          |
| HITCH WEIGHT RATING (LBS)           | 8,000        |



# INTERIOR OPTIONS

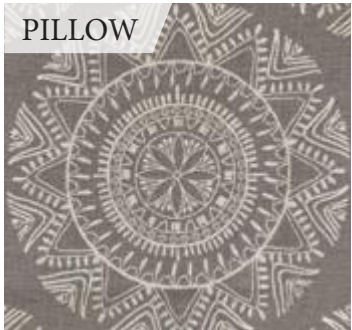

COUNTRY MANOR



TECH SAVVY

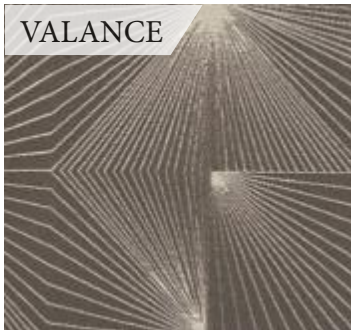

URBAN LOFT





# H O M E   C O L L E C T I O N



ESTATE GREY









# SPECIAL FEATURES



Pull-Out Kibble Station™ with  
FDA Approved Pet Bowl Liner



Exterior TV on Manual Swivel  
with Sound Bar



Pet-Link™ Multi-Purpose  
Tie-Down



10" Touchscreen Dash Radio  
with Bluetooth®, iGo Primo™  
Navigation & Back-up Monitor



Winegard® ConnecT™ 2.0  
WiFi / 4G / TV Antenna



SiriusXM® Radio



Bird's Eye™ Window



Power Drop-Down Hide-Away  
Overhead Bunk with Ladder





# FEATURED HIGHLIGHTS

## CONSTRUCTION & EXTERIOR

- ♦ Ford® F-53 Chassis - 6.8L Triton® V10 Engine, 320HP, 460 lb.-ft. Torque - TorqShift® 6-Speed Automatic Transmission with Overdrive
- ♦ One-Piece Fiberglass Front Cap
- ♦ One-Piece Windshield
- ♦ Welded Tubular Steel Floor
- ♦ Welded Tubular Aluminum Roof & Sidewall Cage Construction
- ♦ Vacu-Bond Laminated Roof, Walls & Floor with Block Foam Insulation
- ♦ Premium One-Piece TPO Roof
- ♦ HD-MAX® Exterior with Graphics Package
- ♦ Automatic Leveling Jacks with Touchpad Controls
- ♦ Side-Hinged Flush Mount Radius Compartment Doors
- ♦ Rotocast Storage Compartments
- ♦ MEGA-Storage™ Compartment (30.4)
- ♦ Pet-Link™ Multi-Purpose Tie-Down
- ♦ Power Patio Awning with Integrated LED Lighting
- ♦ 3TRAX® Wall Slide System (30.4, 32.3 & 33.1)
- ♦ Slideout Room Topper Awning(s)
- ♦ Frameless Windows
- ♦ Motorhome Mudroom™ Compartment
- ♦ Electric Entry Step

- ♦ Roof Ladder
- ♦ 8,000-lb. Trailer Hitch with 7-pin Round Connector

## AUTOMOTIVE & COCKPIT

- ♦ 10" Touchscreen Dash Radio with Bluetooth®, iGo Primo™ Navigation & SiriusXM® Radio
- ♦ Back-Up Monitor
- ♦ Heated/Remote Exterior Mirrors with Integrated Side View Cameras
- ♦ Reclining/Swivel Leatherette Captain's Chairs with Stow-Away Coffee Table
- ♦ Emergency Engine Start Switch
- ♦ Windshield Privacy Shade
- ♦ Conversation Mirrors
- ♦ Cruise Control
- ♦ Tilt Steering Wheel
- ♦ Map Lights
- ♦ Bird's Eye™ Window
- ♦ Valve Stem Extenders on Rear Wheels
- ♦ 19.5" Tires with Stainless Steel Wheel Liners
- ♦ Dash Workstation with 110-volt & 12-volt Outlets
- ♦ Power Drop-Down Hide-Away Overhead Bunk with Bunk Ladder

## INTERIOR

- ♦ Rubber Tread Entry Steps with Lighted Step Well & Utility Storage
- ♦ Residential Vinyl Flooring
- ♦ 84" Interior Ceiling Height
- ♦ LED Lighting
- ♦ Ceiling Ducted Air Conditioning System
- ♦ Flat Panel Cabinet Doors with Nickel Finish Hardware
- ♦ Full Extension Ball-Bearing Metal Drawer Guides
- ♦ Leatherette Sofa Bed
- ♦ Leatherette Theater Seats with Integrated Footrests (33.1)
- ♦ Leatherette Dream Dinette® with Cup Holders
- ♦ Window Privacy Shades
- ♦ 12-volt Attic Fan with Cover in Living Area

## INTERIOR OPTIONS

- ♦ Home Collection Interior Decor Package
- ♦ Single Child Safety Tether in Dream Dinette®

## KITCHEN

- ♦ Double Door Refrigerator
- ♦ 3-Burner Gas Cooktop/Oven with Bi-Fold Glass Cover
- ♦ Microwave Oven
- ♦ Pressed Laminate Countertops

- ♦ Glass Tile Backsplash
- ♦ Oversized Stainless Steel Single Bowl Sink & Single Handle Faucet with Pull-Down Sprayer
- ♦ Pantry (27.2, 30.4 & 33.1)
- ♦ Coat/Broom Closet with Hanging Hooks (27.2)
- ♦ Waste & Recycling Containers

## BEDROOM & BATHROOM

- ♦ King Size Bed (27.2, 32.3 & 33.1)
- ♦ Queen Size Bed (30.3 & 30.4)
- ♦ Dedicated CPAP 12-volt Outlet
- ♦ Designer Headboard, Bedspread & Pillow Shams
- ♦ Bunk Beds with Bunk Ladder (32.3)
- ♦ 12-volt Attic Fan with Cover in Bedroom (27.2)
- ♦ Pull-Out Kibble Station™ with FDA Approved Pet Bowl Liner
- ♦ Foot Flush Porcelain Toilet
- ♦ Laminate Countertops
- ♦ Shower with Curved Rod and Anti-Microbial Curtain (27.2, 30.3 & 33.1)
- ♦ Shower with Glass Door (30.4, & 32.3)

## ENTERTAINMENT

- ♦ 49" TV in Living Area (33.1)
- ♦ 40" TV in Living Area (27.2, 30.4, 32.3 & 33.1)
- ♦ Retractable 40" TV in Living Area (30.3)
- ♦ Blu-Ray Player in Living Area
- ♦ 32" TV in Bedroom
- ♦ Two (2) 15.5" TVs & DVD Player in Bunk Bed Area (32.3)
- ♦ Winegard® Connect™ 2.0 WiFi / 4G / TV Antenna
- ♦ USB Charging Ports
- ♦ Cable TV Ready
- ♦ Digital TV Antenna
- ♦ Exterior 32" TV on Manual Swivel with Sound Bar & Radio
- ♦ Exterior Kitchen with Refrigerator, Sink & 1000-watt Inverter (30.3)

## ELECTRICAL & PLUMBING

- ♦ 30-amp Detachable Shoreline Power Cord, 15,000 BTU Roof Air Conditioner and Onan® RV QG 4000 Gas Generator (27.2)

- ♦ 50-amp Detachable Shoreline Power Cord, Dual 13,500 BTU Roof Air Conditioners, and Onan® RV QG 5500 Gas Generator (30.3, 30.4, 32.3 & 33.1)
- ♦ Solar Prep - Includes Solar Controller
- ♦ Second Auxiliary House Battery
- ♦ Battery Disconnect Switch
- ♦ 6-gallon DSI Gas/Electric Water Heater
- ♦ 360° Siphon® RV Holding Tank Vent Cap
- ♦ 1" Fresh Water Tank Drain
- ♦ Black Tank Flush System
- ♦ Water Heater Bypass System
- ♦ Enclosed & Heated Holding Tanks (27.2, 30.3, 32.3, & 33.1)
- ♦ Enclosed Holding Tanks with Heat Pads (30.4)
- ♦ Outside Shower
- ♦ Systems Control Center
- ♦ Exterior LP Connection

For a complete listing of available features, visit [thormotorcoach.com/ace](http://thormotorcoach.com/ace).







**Made to fit.**

**IMPORTANT—PLEASE READ:** This brochure reflects product design, fabrication, material, components and specifications at the date of printing, which date is disclosed below. Please visit us online at [ThorMotorCoach.com](http://ThorMotorCoach.com) or consult with your selling dealership for the latest in standards, options, specification and technical information. Photographs in the brochure may depict optional equipment or may only be available in certain floor plans. Components, appliances and the chassis may have been manufactured in a calendar year before the vehicle's designated model year. All capacities are approximate. The actual length of the vehicle may differ from that indicated in the brochure due to variances in the manufacturing processes and/or installed components. All dry weights are based on standard model features and do not include optional features or equipment. Component part and appliance manufacturers issue limited warranties covering portions of the vehicle not covered under the limited warranty we issue. Copyright Thor Motor Coach, Inc. © OH 10/01/19



LaMesaRV.com  
800-496-8778

[thormotorcoach.com/ace](http://thormotorcoach.com/ace)

P.O. Box 1486, Elkhart, IN 46515 Sales Department: 800.860.5658 Customer Service: 877.855.2867